

Quick exhaust valves

Connection: 1/8", 1/4", 1/2", 1"

Ideal for industrial applications

High flow rate

Anodised aluminium body
NBR gaskets

3/2 manual operation



TECHNICAL FEATURES

Function	3/2			
Operation	Automatic			
Materials	Body and cover in anodised aluminium alloy NBR gaskets			
Note on materials	Compliant with REACH (1907/2006/EC and subsequent amendments)			
Connections	1/8", 1/4", 1/2", 1" Gas			
Threads	Cylindrical Gas (BSPP)			
Operating temperature	0°C ÷ +80°C (-20°C with dry air, to avoid ice formation)			
Operating pressure	0 ÷ 10 bar			
Air flow rate				
Connection	1/8" Gas	1/4" Gas	1/2" Gas	1" Gas
Nominal diameter	6,0 mm	8,5 mm	11,0 mm	23,0 mm
Supply pressure at 6 bar	620 NI/min	1350 NI/min	3880 NI/min	16000 NI/min
With open exhaust	980 NI/min	2100 NI/min	5400 NI/min	19000 NI/min
Fluid	Filtered air, lubrication-free, compliant with ISO 8573-1:2010 [7:4:4]			
Lubrication	Not required (if required in the pneumatic circuit, it must be continuous)			

QUICK EXHAUST VALVES

AUTOMATIC OPERATION

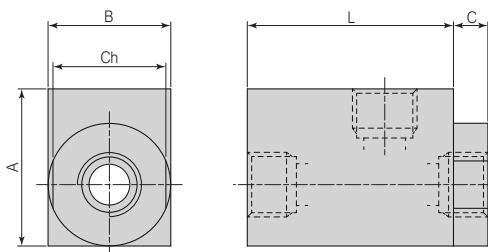

Symbol	Way	Connections	A	B	C	L	Ch	Code
	3/2 NC	Gas 1/8"	23	18	4	35	16	SR-8
		Gas 1/4"	32	25	4	42	23	SR-4
		Gas 1/2"	50	40	7	62	38	SR-2
		Gas 1"	80	60	10	100	50	SR-1