

ACCESSORIES

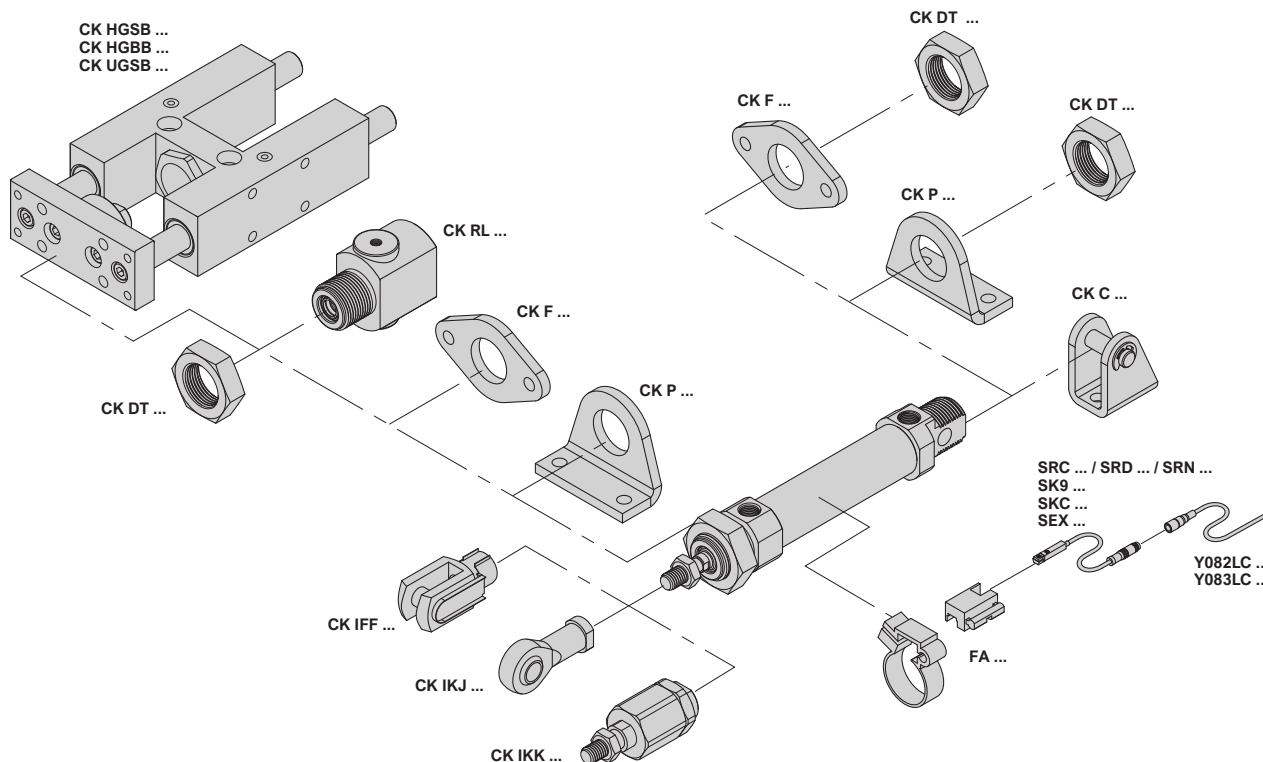

All mounting accessories are supplied complete with screws for fixing to cylinder

The sensors must be purchased with FA .. bracket to mounting on the cylinder (Page 1.1.05.17)

	CK FF ... Female clevis	CK KJ ... Self-lubricating oscillating joint	CK KK ... Self-aligning joint angular and radial	CK DT ... Front cap nut	CK C ... Rear pivot with pin	CK P ... Foot	CK F ... Flange	CK RL ... Static locking unit	CK SG ... Standard seals kit
Ø	Page 1.1.05.10	Page 1.1.05.10	Page 1.1.05.10	Page 1.1.05.11	Page 1.1.05.11	Page 1.1.05.11	Page 1.1.05.11	Page 1.1.05.14	
12	CK FF 12	CK KJ 12	CK KK 12	CK DT 12	CK C 12	CK P 12	CK F 12	CK RL 12	
16	CK FF 16	CK KJ 16	CK KK 16	CK DT 16	CK C 16	CK P 16	CK F 16	CK RL 16	
20	CK FF 20	CK KJ 20	CK KK 20	CK DT 20	CK C 20	CK P 20	CK F 20	CK RL 20	
25	CK FF 25	CK KJ 25	CK KK 25	CK DT 25	CK C 25	CK P 25	CK F 25	CK RL 25	
	Clevis and lockable pins in white galvanized steel	Joint: White galvanized steel Bush: sinterized bronze	Joint and nut in galvanized steel, Pin in blacked steel	Anodized aluminium alloy	Rear pivot and pin: Galvanized steel Seeger: phosphated steel	White galvanized steel	White galvanized steel	Body: Anodised aluminium Jaws: Brass Springs: Spring steel	Rod seals: Polyurethane Other seals: NBR
	CK HGSB ... Piston rod guide H shape with slide bearings support	CK HGBB ... Piston rod guide H shape with ball bearings support	CK UGSB ... Piston rod guide U shape with slide bearings support	SR ... NC sensors REED / HALL	SK9 ... IP69K sensor PNP	SKC ... Precise position sensor PNP	SEX ... ATEX II3G sensor PNP	Y082LC/Y083LC Straight connectors	FA ... Bracket for sensor
Ø	Page 1.1.05.12	Page 1.1.05.12	Page 1.1.05.13	Page 1.1.05.15	Page 1.1.05.16	Page 1.1.05.16	Page 1.1.05.16	Page 1.1.05.17	Page 1.1.05.17
12	CK HGSB 12	CK HGBB 12	CK UGSB 12						FA 12
16	CK HGSB 16	CK HGBB 16	CK UGSB 16						FA 16
20	CK HGSB 20	CK HGBB 20	CK UGSB 20						FA 20
25	CK HGSB 25	CK HGBB 25	CK UGSB 25						FA 25
	Body: Anodised aluminium Rods: Chrome plated steel Bush: Sinterized bronze	Body: Anodised aluminium Rods: Chrome plated steel Bush: Spherical bearings	Body: Anodised aluminium Rods: Chrome plated steel Bush: Sinterized bronze	Sensor: PA6 Cable: PUR	Sensor: PA12 Cable: PUR	Sensor: PA Cable: PUR	Sensor: PA Cable: PVC	Connector: PVC Contacts: Gilded brass Cable: PVC	Bracket: Nylon Screw: White galvanized steel

PISTON ROD ACCESSORIES

CK FF ... Female clevis	Bore mm	Code	AA	AB	ØAC	AD	AE	AF	AG	AH	AL
					h11	h11	±0,5	±0,5		^{+0,30} -0,16	
	12	CK FF 12	6	M6	6	12	12	31	24	±0,3	12 2
	16	CK FF 16	6	M6	6	12	12	31	24		12 2
	20	CK FF 20	8	M8	8	16	16	42	32	±0,4	16 3
	25	CK FF 25	10	M10 x 1,25	10	20	20	52	40		20 3

CK FF ... Clevis and clip in zinc plated steel / 1 piece each package

CK KJ ... Self-lubricating oscillating joint	Bore mm	Code	AB	ØAC	AM	AN	AO	AP	AQ	ØAR	ØAS	ØAT	AU	AV	AZ
				H7		Ch									
	12	CK KJ 12	M6	6	12	11	20	9	6,75	8,9	10	13	5	30	40
	16	CK KJ 16	M6	6	22	11	20	9	6,75	8,9	10	13	5	30	40
	20	CK KJ 20	M8	8	28	14	24	12	9	10,4	12,5	16	5	36	48
	25	CK KJ 25	M10 x 1,25	10	28	17	28	14	10,5	12,9	15	19	6,5	43	57

CK KJ ... Joint in zinc plated steel, bush in sintered bronze, ring in hardened bearing steel / 1 piece each package

CK KK ... Self-aligning joint angular and radial	Bore mm	Code	A	B	C	D	E	ØF	ØG	ØH	L	M	Ch1	Ch2	Ch3	°β	Static load daN
	12	CK KK 12	M6	35	11	2,5	17,5	6	8,5	14,5	1	12,5	5	7	13	6	120
	16	CK KK 16	M6	35	11	2,5	17,5	6	8,5	14,5	1	12,5	5	7	13	6	120
	20	CK KK 20	M8	57	21	5	26	8	12,5	19	2	16	7	11	17	8	250
	25	CK KK 25	M10 x 1,25	71,5	20	7,5	35	14	22	32	2	22	12	19	30	8	500

CK KK ... Joint and nut in zinc plated steel, pin in burnished steel / 1 piece each package

MOUNTING ACCESSORIES

CK DT ... Front cap nut	Bore mm	Code	M	T	Ch2
	12	CK KK 12	M16 x 1,5	6	24
	16	CK KK 16	M16 x 1,5	6	24
	20	CK KK 20	M22 x 1,5	10	32
	25	CK KK 25	M22 x 1,5	10	32

CK DT ... Front cap nut in anodized aluminium alloy / 1 piece each package

CK C ... Rear pivot with pin	Bore mm	Code	C ±0,2	ØD H13	E + ±1	E1	F1	G ±0,2	G1 ^{+0,20} ₀	ØH1 f8	N1	R1	U JS13	V
	12	CK C 12	27	5,5	75	25	5	2,5	12,1	6	18	7	15	18
	16	CK C 16	27	5,5	82	25	5	2,5	12,1	6	18	7	15	18
	20	CK C 20	30	6,6	95	32	6	3	16,1	8	24	10	20	22
	25	CK C 25	30	6,6	104	32	6	3	16,1	8	24	10	20	22

CK C ... Rear pivot and pin in zinc plated steel , seeger in phosphated steel / 1 piece each package

CK P ... Foot	Bore mm	Code	A JS13	B	C2 ±0,2	ØD H13	E	F	G2 ±0,2	H	L +	M	S
	12	CK P 12	32	31,5	20	5,5	20	6	4	42	75,5	7,5	13
	16	CK P 16	32	32	20	5,5	20	6	4	42	82	8	13
	20	CK P 20	40	36	25	6,6	25	8	5	54	99	7	20
	25	CK P 25	40	40	25	6,6	25	8	5	54	104	11	20

CK P ... Foot in zinc plated steel / 1 piece each package

CK F ... Flange	Bore mm	Code	D H13	N	O JS13	P	Q	R ±0,2	T +
	12	CK F 12	5,5	52	40	52	17,5	4	73,5
	16	CK F 16	5,5	52	40	52	18	4	80
	20	CK F 20	6,6	66	50	66	19	5	94
	25	CK F 25	6,6	66	50	66	23	5	103

CK F ... Flange in zinc plated steel / 1 piece each package