

CD Series

According to ISO 15552 standards



ISO 9001
BUREAU VERITAS
Certification

N° IT275286



Bonesi
Pneumatik



Cylinders according to ISO 15552 standards - CD Series

Bores Ø : 160 - 200 - 250 - 320 mm.

1

PNEUMATIC ACTUATORS

SERIES CD



Robust cylinders for heavy duty application

According to ISO 15552 standards

Die-cast or gravity cast aluminium heads and caps, epoxy painted.

Steel C45 piston rod, ground and hard chromium plated

Anodized aluminium profiled tube, internally gauged

Zinc plated steel tie rods

Adjustable end of stroke pneumatic cushions

Aluminium piston

Sensors and mounting accessories

TECHNICAL FEATURES

Construction	Tube closed on both ends with a cap and head by tie rods
Function	Double acting
Standard materials	Die-cast or gravity cast aluminium heads and caps, epoxy painted, piston rod in steel C45 ground and hard chromium plated. Round tube in anodized aluminium internally gauged, aluminium piston. Seals in NBR - PU
Note about the materials	REACH regulation EC (2023/2482 and s.a.s.)
Bores	Ø 160, 200, 250, 320 mm
Standard strokes (min. - max.)	25 mm ÷ 2000 mm
Special strokes (on request)	Up to 3000 mm
Working temperature	0 ÷ 80°C (standard seals, -20°C with dry air, in order to avoid formation of ice) 0 ÷ 150°C (option in FKM, -20°C with dry air, in order to avoid formation of ice)
Working pressure	0,5 ÷ 10 bar
Fluid	Filtered air without lubrication , according to ISO 8573-1:2010 [7:4:4]
Speed	10 ÷ 1000 mm/sec

CERTIFICAZIONE ATEX

Cylinder marking	CE Ex II 2G Ex h IIC T6 Gb (Zona 1 e Zona 2) CE Ex II 2D Ex h IIIC 85°C Db (Zona 21 e Zona 22)
Operating pressure in ATEX environment	0,5 ÷ 10 bar
Temperature in ATEX environment	-20°C ≤ Ta ≤ +60°C
CE marking	According to Directive 2014/34/EU (see declaration of conformity)

TECHNICAL FEATURES

	160	200	250	320
Bore Ø (mm)	160	200	250	320
Ports (gas)	3/4"	3/4"	1"	1"
Piston rod Ø (mm)	40	40	50	63
Thread of the piston rod (male)	M36 x 2	M36 x 2	M42 x 2	M48 x 2
Theoretical forward force at 6 bar (N)	11831	18482	28900	47335
Theoretical backward force at 6 bar (N)	11090	17740	27723	45500
Air consumption at 6 bar in forward force (Nl/cm)	1,407	2,198	3,473	5,629
Air consumption at 6 bar in backward force (Nl/cm)	1,312	2,110	3,297	5,411
Cushioning stroke (mm)	37	37	42	54

ORDERING CODE

Series CD	Magnetic ring <input type="checkbox"/>	Piston rod options <input type="checkbox"/>	Bore 160	Piston rod stroke 0500	Manufacturing variants <input type="checkbox"/>	According to directive 2014/34/EU - ATEX <input type="checkbox"/>
CD = Double acting, standard rod, not magnetic, end of stroke adjustable cushioning.	M = With magnetic ring = Without magnetic ring	P = Double ended = Standard rod	160 = Ø 160 mm 200 = Ø 200 mm 250 = Ø 250 mm 320 = Ø 320 mm	See table "standard strokes" Other strokes available on request		EX = According to 2014/34/EU = Without certifications
<p>NX = Piston rod and nut in AISI 304 (X5 Cr Ni 1810) HR = Piston rod, tie rods and nuts in AISI 304 (X5 Cr Ni 1810) - Epoxy paint FKM = Seals for high temperatures (-20°C ÷ 150°C) FKMS = Rod seal in FKM, others as standard A = Round tube in steel internally polished and chromed AR = Low friction version MT4 = Intermediate hinge = No variants to the standard</p>						

STANDARD STROKES

Ø	25	50	75	80	100	125	150	160	200	250	300	320	350	400	450	500	600	700	800	900	1000	1200	1400	1600	1800	2000
160	x	x	x	x	x	x	x	x	x	x	x	x	x	x	x	x	x	x	x	x	x	x	x	x	x	x
200	x	x	x	x	x	x	x	x	x	x	x	x	x	x	x	x	x	x	x	x	x	x	x	x	x	x
250	x	x	x	x	x	x	x	x	x	x	x	x	x	x	x	x	x	x	x	x	x	x	x	x	x	x
320	x	x	x	x	x	x	x	x	x	x	x	x	x	x	x	x	x	x	x	x	x	x	x	x	x	x

STANDARD MATERIALS

POS	DESCRIPTION	MATERIAL	POS	DESCRIPTION	MATERIAL
①	Caps	Aluminium epoxy paint	⑩	Round tube	Extruded aluminum EN AW-6060 T6
②	Piston rod seal	Nitril rubber (NBR)	⑪	Rod	Chromed steel C45, 20 µm
③	Guide bushing	Steel + PTFE	⑫	Rod nut	Zinc-plated steel
④	Cushion seal	Nitril rubber (NBR)	⑬	Piston	Aluminium gravity cast
⑤	Cap seal	Nitril rubber (NBR)	⑭	Retaining ring	Spring steel
⑥	Cushion screw	Nickel-plated brass	⑮	Piston seal	Nitril rubber (NBR)
⑦	Retaining ring	Nickel-plated brass	⑯	Wear ring	Carbografito
⑧	Cushion screw seal	Nitril rubber (NBR)	⑰	Flat washer	Zinc-plated steel
⑨	Bolt for fixing cap	Zinc-plated steel	⑱	Piston nut - rod	Zinc-plated steel

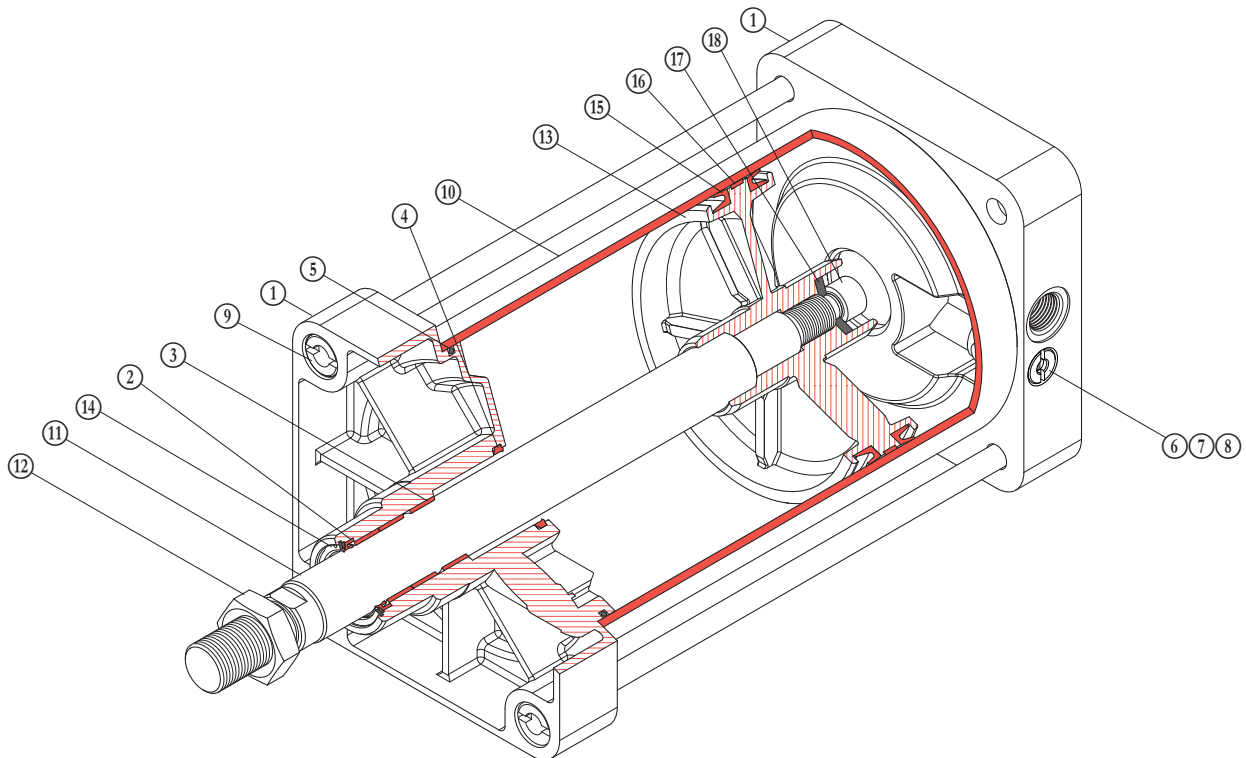

CD... / CDM...

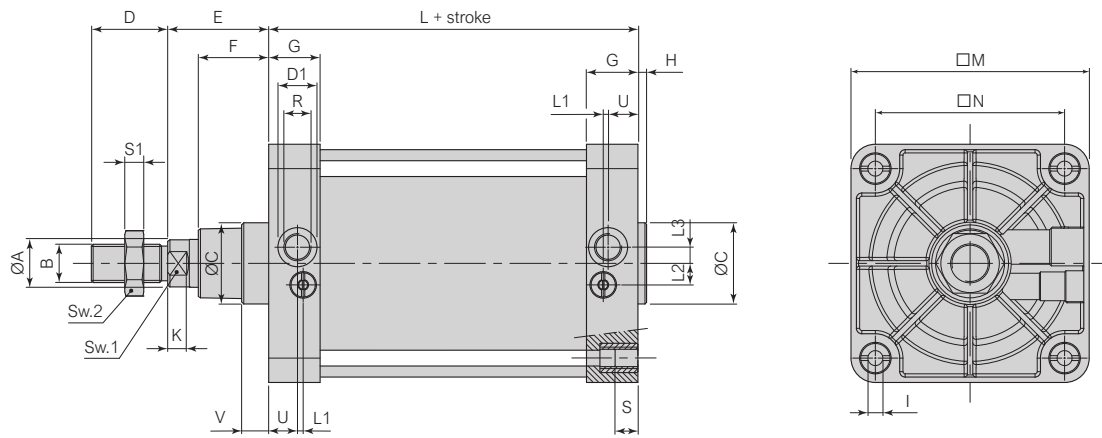

Bore mm	Ø A f7	B	Ø C d11	D 0 -2	D1	E	F	G	H	I	K	L+	L1	L2	L3	M	N	R		S		S1		SW1 SW2		U	V
																		Min	Ch	Ch	Ch	Ch	Ch				
160	40	M36 x 2	65	72	33	80	±2,2	50	47,5	6	M16	16	180	±1,1	4,5	20	15	180	140	±1,1	Gas 3/4"	24	18	36	55	27,5	8
200	40	M36 x 2	75	72	33	95		65	47,5	6	M16	16	180	4,5	20	15	220	175	Gas 3/4"		24	18	36	55	27,5	8	
250	50	M42 x 2	90	84	40	105	±2,2	73,5	55	9	M20	20	200	±1,6	-	37	-	270	220	±1,5	Gas 1"	25	21	46	65	31	20
320	63	M48 x 2	110	96	40	120		90	57	10	M24	24	220	-	37	-	345	270	Gas 1"		28	24	55	75	31	11,5	

CDP... / CDMP...

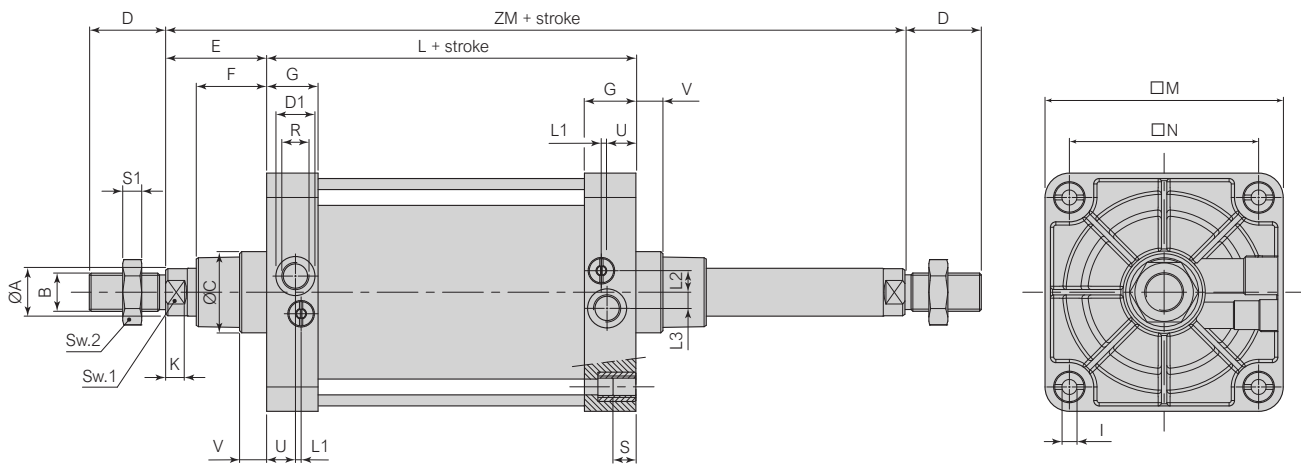
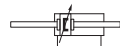

Bore mm	Ø A f7	B	Ø C d11	D 0 -2	D1	E	F	G	I	K	L+	L1	L2	L3	M	N	R		S		S1		SW1 SW2		U	V	ZM+	
																	Min	Ch	Ch	Ch	Ch	Ch						
160	40	M36 x 2	65	72	33	80	±2,2	50	47,5	M16	16	180	±1,1	4,5	20	15	180	140	±1,1	Gas 3/4"	24	18	36	55	27,5	8	340	+3,5 -2,0
200	40	M36 x 2	75	72	33	95		65	47,5	M16	16	180	4,5	20	15	220	175	Gas 3/4"		24	18	36	55	27,5	8	370		
250	50	M42 x 2	90	84	40	105	±2,2	73,5	55	M20	20	200	±1,6	-	37	-	270	220	±1,5	Gas 1"	25	21	46	65	31	20	410	+4,0 -2,5
320	63	M48 x 2	110	96	40	120		90	57	M24	24	220	-	37	-	345	270	Gas 1"		28	24	55	75	31	11,5	460		

ACCESSORIES

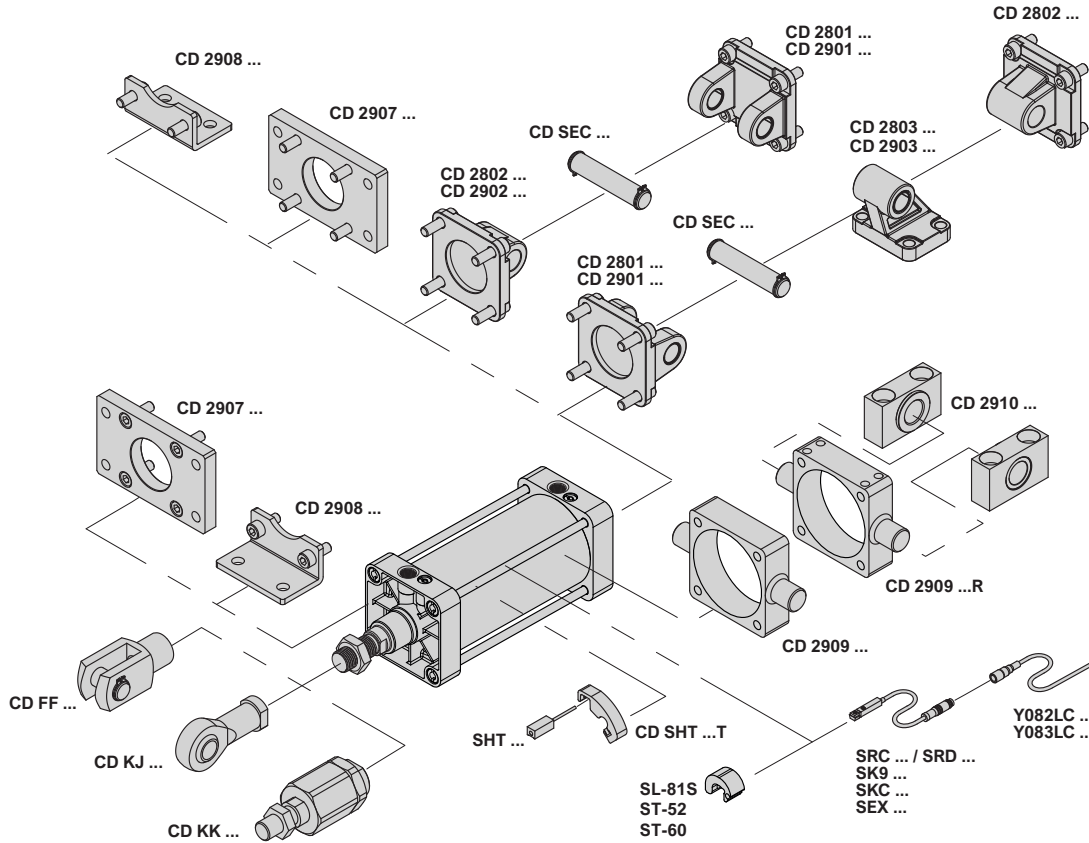

All mounting accessories are supplied complete with screws for fixing to cylinder

CD FF ... Female clevis with pin	CD KJ ... Self-lubricating oscillating joint	CD KK ... Self-aligning joint angular and radial	CD 2801 ... Female hinge (MP2)	CD 2901 ... Female hinge(MP2)	CD 2802 ... Male hinge (MP4)	CD 2902 ... Male hinge (MP4)	CD 2803 ... Square joint at 90° (AB7)	CD 2903 ... Square joint at 90° (AB7)
Page 1.3.20.6	Page 1.3.20.6	Page 1.3.20.6	Page 1.3.20.7	Page 1.3.20.7	Page 1.3.20.7	Page 1.3.20.7	Page 1.3.20.7	Page 1.3.20.7
160 CD FF 160	CD KJ 160	CD KK 160	CD 2801 160	CD 2901 160	CD 2802 160	CD 2902 160	CD 2803 160	CD 2903 160
200 CD FF 200	CD KJ 200	CD KK 200	CD 2801 200	CD 2901 200	CD 2802 200	CD 2902 200	CD 2803 200	CD 2903 200
250 CD FF 250	CD KJ 250	-	CD 2801 250	CD 2901 250	CD 2802 250	CD 2902 250	CD 2803 250	CD 2903 250
320 CD FF 320	CD KJ 320	-	CD 2801 320	CD 2901 320	CD 2802 320	CD 2902 320	CD 2803 320	CD 2903 320
Clevis and lockable pins in galvanized steel	Joint in galvanized steel, bush in sinterized bronze	Joint and nut in galvanized steel, Pin in blacked steel	Light alloy	Painted steel black cataphoresis	Light alloy	Painted steel black cataphoresis	Light alloy	Painted steel black cataphoresis
CD 2907 ... Front and rear flange (MF1-MF2)	CD 2908 ... Low foot pedestal (MS1)	CD 2909 ... Not adjustable intermediate hinge	CD 2909 ...R Adjustable intermediate hinge (MT4)	CD 2910 ... Support for intermediate hinge (AT4)	CD SEC ... Pin for female hinge MP2 (AA4)			
Page 1.3.20.7	Page 1.3.20.8	Page 1.3.20.8	Page 1.3.20.8	Page 1.3.15.9	Page 1.3.20.9			
160 CD 2907 160	CD 2908 160	CD 2909 160	CD 2909 160R	CD 2910 160	CD SEC 160			
200 CD 2907 200	CD 2908 200	CD 2909 200	CD 2909 200R	CD 2910 200	CD SEC 200			
250 CD 2907 250	CD 2908 250	CD 2909 250	CD 2909 250R	CD 2910 250	CD SEC 250			
320 CD 2907 320	CD 2908 320	CD 2909 320	CD 2909 320R	CD 2910 320	CD SEC 320			
White zinc coating steel	White zinc coating steel	White zinc coating steel	White zinc coating steel	White zinc coating steel Bush in sinterized bronze	White zinc coating steel			

ACCESSORIES								
	CD SG ... Standard seals kit	CD SGV ... High temperature seals kit	CD SGVS ... Seals kit, rod in FKM other as standard	CDM SG ... Standard seals kit Magnetic	CDM SGV ... High temperature seals kit Magnetic			
Ø								
160	CX SG 160	CX SGV 160	CX SGVS 160	CXM SG 160	CXM SGV 160			
200	CX SG 200	CX SGV 200	CX SGVS 200	CXM SG 200	CXM SGV 200			
250	CX SG 250	CX SGV 250	CX SGVS 250	CXM SG 250	CXM SGV 250			
320	CX SG 320	CX SGV 320	CX SGVS 320	CXM SG 320	CXM SGV 320			
	Rod seals: Polyurethane Other seals: NBR	Seals in FKM	Rod seals: FKM Other seals: NBR	Rod seals: Polyurethane Other seals: NBR	Seals in FKM			
	SR ... NC sensors REED / HALL	SK9 ... IP69K sensor PNP	SKC ... Precise position sensor PNP	SEX ... ATEX IIG sensor PNP	SHT ... High temperature sensor REED	Y082LC/Y083LC Straight connectors	SL-... / ST- ... Bracket for sensor	CD SHT ...T Bracket for sensor SHT
Ø	Page 1.3.20.10	Page 1.3.20.11	Page 1.3.20.11	Page 1.3.20.11	Page 1.3.20.12	Page 1.3.20.12	Page 1.3.20.13	Page 1.3.20.13
160							SL-81S	CD SHT 160T
200							SL-81S	CD SHT 200T
250							ST-60	CD SHT 250T
320							ST-52	CD SHT 320T
	Sensor: PA6 Cable: PUR	Sensor: PA12 Cable: PUR	Sensor: PA Cable: PUR	Sensor: PA Cable: PVC	Sensor: Aluminium Cable: PTFE	Connector: PVC Contacts: Gilded brass Cable: PVC	Bracket: Anodised aluminium Screw and plate: steel	Bracket: Anodised aluminium Screw and plate: steel

PISTON ROD ACCESSORIES

CD FF ... Female clevis with pin	Bore mm	Code	AA	AB	Ø AC	AD	AE	AF	AG	AH	
	160	CD FF 160	35	$\begin{matrix} +0,70 \\ +0,15 \end{matrix}$	M36 x 2,0	35	70	72	188	144	84
	200	CD FF 200	35		M36 x 2,0	35	70	72	188	144	84
	250	CD FF 250	40		M42 x 2,0	40	85	84	232	168	104,3
	320	CD FF 320	50		M48 x 2,0	50	96	96	265	192	117,3
CD FF ... Clevis and clip in zinc plated steel / 1 piece each package											

CD KJ ... Self-lubricating oscillating joint	Bore mm	Code	AB	Ø AC	AM	AN	AO	AP	AQ	Ø AR	Ø AS	Ø AT	AU	AV	AZ
	160	CD KJ 160	M36 x 2,0	35	56	50	80	43	28	37,7	46	58	17	125	165
	200	CD KJ 200	M36 x 2,0	35	56	50	80	43	28	37,7	46	58	17	125	165
	250	CD KJ 250	M42 x 2,0	40	60	55	91	49	33	45,1	53	65	19	142	187
	320	CD KJ 320	M48 x 2,0	50	65	65	117	60	45	56,6	65	75	23	162	218
CD KJ ... Joint in zinc plated steel, bush in sintered bronze, ring in hardened bearing steel / 1 piece each package															

CD KK ... Self-aligning joint angular and radial	Bore mm	Code	A	B	C	D	E	Ø F	Ø G	Ø H	L	M	Ch1	Ch2	Ch3	°β	Static load daN
	160	CD KK 160	M36 x 2,0	190	72	15,5	77	39	57	75	2	68	32	54	70	8	4000
	200	CD KK 200	M36 x 2,0	190	72	15,5	77	39	57	75	2	68	32	54	70	8	4000
CD KK ... Joint and nut in zinc plated steel, pin in burnished steel / 1 piece each package																	

ACCESSORI DI FISSAGGIO

CD 2801 ... / CD 2901 ...

Female hinge (MP2)

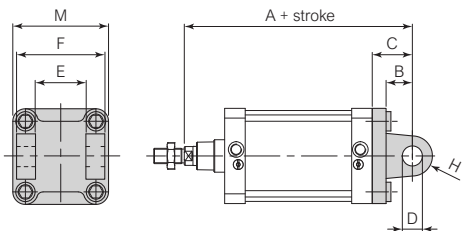

Bore mm	Code	A+	B	C	D	E	F	M	H	Fixing screw
160	CD 2801 160 CD 2901 160	315	35	55	30	90	170	180	30	M16 x 30
200	CD 2801 200 CD 2901 200	335 ±2,0	35	60	30	90	170	220	30	M16 x 30
250	CD 2801 250 CD 2901 250	375	45	70	40	110	200	270	40	M20 x 30
320	CD 2801 320 CD 2901 320	420 ±2,5	50	80	45	120	220	350	45	M24 x 40

CD 2801 ... Light alloy / CD 2901 ... Painted steel black cataphoresis / 1 piece each package + 4 screws for fixing to cylinder

CD 2802 ... / CD 2902 ...

Male hinge (MP4)

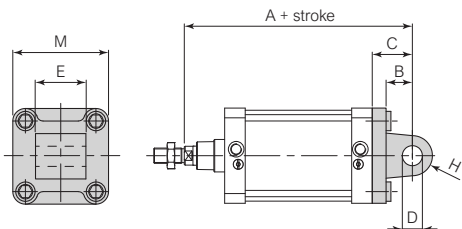

Bore mm	Code	A+	B	C	D	E	M	H	Fixing screw
160	CD 2802 160 CD 2902 160	315	35	55	30	90	180	30	M16 x 30
200	CD 2802 200 CD 2902 200	335 ±2,0	35	60	30	90	220	30	M16 x 30
250	CD 2802 250 CD 2902 250	375	45	70	40	110	270	40	M20 x 30
320	CD 2802 320 CD 2902 320	420 ±2,5	50	80	45	120	350	45	M24 x 40

CD 2802 ... Light alloy / CD 2902 ... Painted steel black cataphoresis / 1 piece each package + 4 screws for fixing to cylinder

CD 2803 ... / CD 2903 ...

Square joint at 90° (AB7)

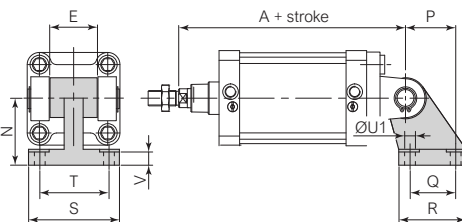

Bore mm	Code	A+	E	N	P	Q	R	S	T	ØU1	V
160	CD 2803 160 CD 2903 160	315 ±2,0	90	115	97	88	126	156	118	14	23
200	CD 2803 200 CD 2903 200	335	90	135	105	90	130	162	122	18	30

CD 2803 ... Light alloy / CD 2903 ... Painted steel black cataphoresis / 1 piece each package

CD 2907 ...

Front and rear flange ISO (MF1-MF2)

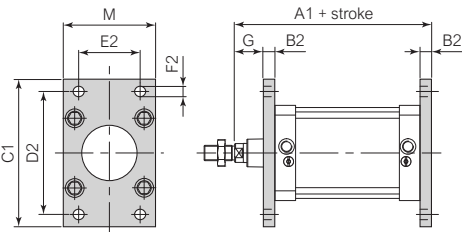

Bore mm	Code	A1+	B2	C1	D2	E2	F2	G	M	Vite di ancoraggio
160	CD 2907 160	280	20	260	230	115	18	60	180	M16 x 30
200	CD 2907 200	300 ±2,0	25	310	270	135	22	70	220	M16 x 30
250	CD 2907 250	330	25	390	330	165	26	80	270	M20 x 30
320	CD 2907 320	370 ±2,5	30	460	400	200	33	90	350	M24 x 40

CD 2907 ... White zinc plated steel / 1 piece each package + 4 screws for fixing to cylinder

MOUNTING ACCESSORIES

CD 2908 ... Low foot pedestal (MS1)	Bore mm	Code	A2+	B3	C2	E2	Ø G1	M	N	Q1+	V1	Vite di ancoraggio ISO 4762		
				±0,2		JS14 H14			JS16		±0,5			
	160	CD 2908 160	144		24	35	32	7	45	32	142	4	M6 x 18	
	200	CD 2908 200	163	±1,25	28	36	36	9	52	36	161	±1,25	4	M6 x 18
	250	CD 2908 250	175		32	47	45	9	65	45	170		5	M8 x 20
	320	CD 2908 320	190	±1,6	32	45	50	9	75	50	185	±1,6	5	M8 x 20
CD 2908 ... White zinc plated steel / 1 piece each package + 2 screws for fixing to cylinder														

CD 2909 ... Not adjustable intermediate hinge (MT4)	Bore mm	Code	A3 h14	B4 h14	C3	Ø D3 e9	E3	Xmin	Xmax +
	160	CD 2909 160	200	32	198	32	40	148	193
	200	CD 2909 200	250	32	245	32	40	163	210
	250	CD 2909 250	320	40	304	40	50	185	225
	320	CD 2909 320	400	50	370	50	60	207	253
CD 2909 ... White zinc plated steel / 1 piece each package									

CD 2909 ...R Adjustable intermediate hinge	Bore mm	Code	A3 h14	B4 h14	C3	Ø D3 e9	E3	Xmin	Xmax +
	160	CD 2909 160R	200	32	190	32	40	148	193
	200	CD 2909 200R	250	32	240	32	40	163	210
	250	CD 2909 250R	320	40	295	40	50	185	225
	320	CD 2909 320R	400	50	370	50	70	212	248
CD2909 ... R White zinc plated steel / 1 piece each package + 8 set head screws for fixing to cylinder									

CD 2910 ... Support for intermediate hinge (AT4)	Bore mm	Code	A3 h14	A4	B5	C4	Ø D3	E4	F3	Ø G2	Ø G3	M1	N1
							F7	±0,2	±0,5	H13	H13		±0,1
	160	CD 2910 160	200	92	245	280	32	60	17	18	26	60	30
	200	CD 2910 200	250	92	295	330	32	60	17	18	26	60	30
	250	CD 2910 250	320	140	382	382	40	90	20	22	33	70	35
	320	CD 2910 320	400	150	465	520	50	100	25	26	39	80	40
CD 2910 ... White zinc plated steel, bush in sintered bronze / 2 pieces each package													

MOUNTING ACCESSORIES

CD SEC ...

Pin for female hinge MP2 (AA4)

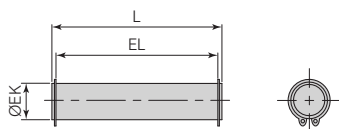

Bore mm	Code	Ø EK e8	EL $+0,3$ 0	L
160	CD SEC 160	30	171,5	178
200	CD SEC 200	30	171,5	178
250	CD SEC 250	40	202	211
320	CD SEC 320	45	222	236

CD SEC ... White zinc plated steel / 1 piece each package + 2 retaining rings DIN 471

END OF STROKE SENSORS TYPE SR

SRC-61, SRC-21, SRC-27

End of stroke sensor REED - 2 poles N.O.

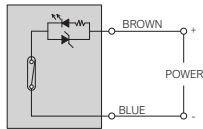
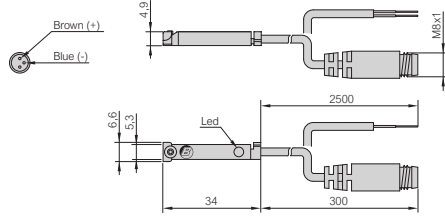

Technical features

Code	SRC-61	SRC-21	SRC-27
Version	Cable 2 x 0,14 mm ²	Cable 2 x 0,14 mm ²	Connector M8 x 1 - 2 pin
Cable length	2500 mm	2500 mm	300 mm
Sensor	REED		
Output	Pure contact, normally open		
Operating voltage	5 ÷ 230 Vac / Vdc	5 ÷ 130 Vac / Vdc	5 ÷ 50 Vac / Vdc
Switching current (max.)	200 mA	200 mA	200 mA
Contact rating (max.)	10 W	6 W	6 W
Voltage drop (max.)	3 V	3 V	3 V
Visual indicator	LED yellow diode		
Operating frequency	1000 Hz		
Working temperature	-15 ÷ +70 °C		
Protection class (IEC 60529))	IP67		
Protection circuit	Power source reverse polarity		
Mounting	Screw for "T" groove - Torque max. 0,15 Nm		

SRC-61, SRC-21, SRC-27 / Sensor in PA6, cable in PUR - 1 piece each package

SRD-21, SRD-27

End of stroke sensor REED - 3 poles N.O.

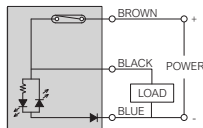
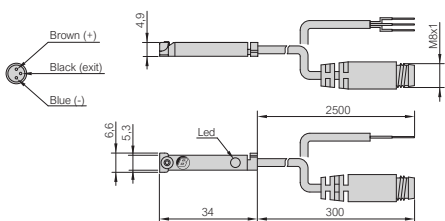

Technical features

Code	SRD-21	SRD-27
Version	Cable 3 x 0,14 mm ²	Connector M8 x 1 - 3 pin
Cable length	2500 mm	300 mm
Sensor	REED	
Output	PNP, normally open	
Operating voltage	5 ÷ 30 Vac / Vdc	
Switching current (max.)	200 mA	
Contact rating (max.)	6 W	
Voltage drop (max.)	0,7 V	
Visual indicator	LED yellow diode	
Operating frequency	1000 Hz	
Working temperature	-15 ÷ +70 °C	
Protection class (IEC 60529))	IP67	
Protection circuit	Power source reverse polarity	
Mounting	Screw for "T" groove - Torque max. 0,15 Nm	

SRD-21, SRD-27 / Sensor in PA6, cable in PUR - 1 piece each package

SRN-21, SRN-27

End of stroke sensor HALL PNP - 3 poles N.O.

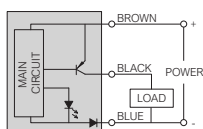
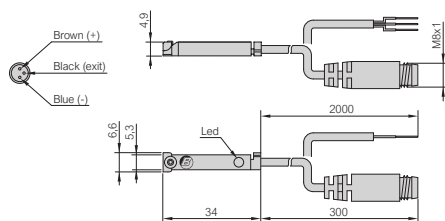

Technical features

Code	SRN-21	SRN-27
Version	Cable 3 x 0,14 mm ²	Connector M8 x 1 - 3 pin
Cable length	2000 mm	300 mm
Sensor	HALL	
Output	PNP, normally open	
Operating voltage	10 ÷ 30 Vdc	
Switching current (max.)	200 mA	
Contact rating (max.)	4 W	
Voltage drop (max.)	0,7 V	
Visual indicator	LED yellow diode	
Operating frequency	1000 Hz	
Working temperature	-15 ÷ +70 °C	
Protection class (IEC 60529))	IP67	
Protection circuit	Power source reverse polarity	
Mounting	Screw for "T" groove - Torque max. 0,15 Nm	

SRN-21, SRN-27 / Sensor in PA6, cable in PUR - 1 piece each package

END OF STROKE SENSORS TYPE SK9 with enclosure classification IP69K

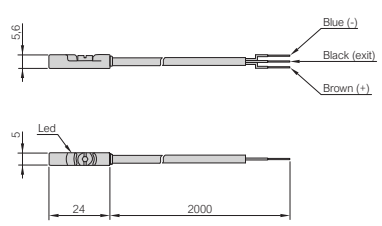
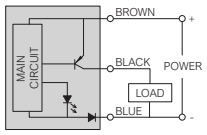
<p>SK9-21 End of stroke sensor HALL PNP - 3 poles N.O.</p> 	<p>Technical features</p>																				
	<table border="1"> <tr><td>Code</td><td>SK9-21</td></tr> <tr><td>Version</td><td>Cable 3 x 0,14 mm²</td></tr> <tr><td>Cable length</td><td>2000 mm</td></tr> <tr><td>Sensor</td><td>HALL</td></tr> <tr><td>Output</td><td>PNP, normally open</td></tr> <tr><td>Operating voltage</td><td>10 ÷ 30 Vdc</td></tr> <tr><td>Switching current (max.)</td><td>200 mA</td></tr> <tr><td>Contact rating (max.)</td><td>6 W</td></tr> <tr><td>Current consumption</td><td>10 mA (without load)</td></tr> <tr><td>Voltage drop (max.)</td><td>2,2 V</td></tr> </table>	Code	SK9-21	Version	Cable 3 x 0,14 mm ²	Cable length	2000 mm	Sensor	HALL	Output	PNP, normally open	Operating voltage	10 ÷ 30 Vdc	Switching current (max.)	200 mA	Contact rating (max.)	6 W	Current consumption	10 mA (without load)	Voltage drop (max.)	2,2 V
Code	SK9-21																				
Version	Cable 3 x 0,14 mm ²																				
Cable length	2000 mm																				
Sensor	HALL																				
Output	PNP, normally open																				
Operating voltage	10 ÷ 30 Vdc																				
Switching current (max.)	200 mA																				
Contact rating (max.)	6 W																				
Current consumption	10 mA (without load)																				
Voltage drop (max.)	2,2 V																				
	<table border="1"> <tr><td>Visual indicator</td><td>LED yellow diode: flashing (instable position) permanently light (stable position)</td></tr> <tr><td>Operating frequency</td><td>1000 Hz</td></tr> <tr><td>Temperature range</td><td>-30 ÷ +80 °C</td></tr> <tr><td>Enclosure classification (DIN 40050)</td><td>IP69K</td></tr> <tr><td>Protection circuit</td><td>Short-circuit, power source reverse polarity, power-up pulse</td></tr> <tr><td>Mounting</td><td>Screw for "T" groove - Torque max. 0,3 Nm</td></tr> </table> <p>SK9-21 / Sensor in PA12, cable in PUR - 1 piece each package</p>	Visual indicator	LED yellow diode: flashing (instable position) permanently light (stable position)	Operating frequency	1000 Hz	Temperature range	-30 ÷ +80 °C	Enclosure classification (DIN 40050)	IP69K	Protection circuit	Short-circuit, power source reverse polarity, power-up pulse	Mounting	Screw for "T" groove - Torque max. 0,3 Nm								
Visual indicator	LED yellow diode: flashing (instable position) permanently light (stable position)																				
Operating frequency	1000 Hz																				
Temperature range	-30 ÷ +80 °C																				
Enclosure classification (DIN 40050)	IP69K																				
Protection circuit	Short-circuit, power source reverse polarity, power-up pulse																				
Mounting	Screw for "T" groove - Torque max. 0,3 Nm																				

END OF STROKE SENSORS TYPE SKC with precise positioning sistem

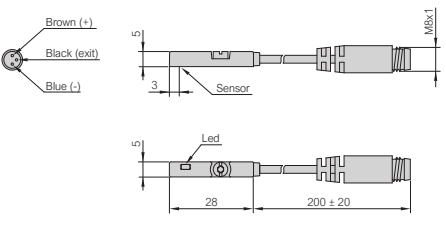
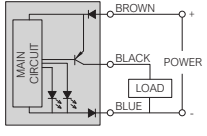
<p>SKC-27 End of stroke sensor HALL PNP - 3 poles N.O.</p> 	<p>Technical features</p>																				
	<table border="1"> <tr><td>Code</td><td>SKC-27</td></tr> <tr><td>Version</td><td>Connector M8 x 1 - 3 pin</td></tr> <tr><td>Cable length</td><td>200 mm</td></tr> <tr><td>Sensor</td><td>HALL</td></tr> <tr><td>Output</td><td>PNP, normally open</td></tr> <tr><td>Operating voltage</td><td>10 ÷ 28 Vdc</td></tr> <tr><td>Switching current (max.)</td><td>80 mA</td></tr> <tr><td>Contact rating (max.)</td><td>2 W</td></tr> <tr><td>Current consumption</td><td>10 mA (24 Vdc)</td></tr> <tr><td>Voltage drop (max.)</td><td>1,5 V</td></tr> </table>	Code	SKC-27	Version	Connector M8 x 1 - 3 pin	Cable length	200 mm	Sensor	HALL	Output	PNP, normally open	Operating voltage	10 ÷ 28 Vdc	Switching current (max.)	80 mA	Contact rating (max.)	2 W	Current consumption	10 mA (24 Vdc)	Voltage drop (max.)	1,5 V
Code	SKC-27																				
Version	Connector M8 x 1 - 3 pin																				
Cable length	200 mm																				
Sensor	HALL																				
Output	PNP, normally open																				
Operating voltage	10 ÷ 28 Vdc																				
Switching current (max.)	80 mA																				
Contact rating (max.)	2 W																				
Current consumption	10 mA (24 Vdc)																				
Voltage drop (max.)	1,5 V																				
	<table border="1"> <tr><td>Leakage current (max.)</td><td>0,05 mA</td></tr> <tr><td>Visual indicator</td><td>Two colors LED diode: red (instable position) green (stable position)</td></tr> <tr><td>Operating frequency</td><td>1000 Hz</td></tr> <tr><td>Temperature range</td><td>-10 ÷ +60 °C</td></tr> <tr><td>Enclosure classification (DIN 40050)</td><td>IP67</td></tr> <tr><td>Protection circuit</td><td>Short-circuit, power source reverse polarity, power-up pulse</td></tr> <tr><td>Mounting</td><td>Screw for "T" groove - Torque max. 0,3 Nm</td></tr> </table> <p>SKC-27 / Sensor in PA, cable in PUR - 1 piece each package</p>	Leakage current (max.)	0,05 mA	Visual indicator	Two colors LED diode: red (instable position) green (stable position)	Operating frequency	1000 Hz	Temperature range	-10 ÷ +60 °C	Enclosure classification (DIN 40050)	IP67	Protection circuit	Short-circuit, power source reverse polarity, power-up pulse	Mounting	Screw for "T" groove - Torque max. 0,3 Nm						
Leakage current (max.)	0,05 mA																				
Visual indicator	Two colors LED diode: red (instable position) green (stable position)																				
Operating frequency	1000 Hz																				
Temperature range	-10 ÷ +60 °C																				
Enclosure classification (DIN 40050)	IP67																				
Protection circuit	Short-circuit, power source reverse polarity, power-up pulse																				
Mounting	Screw for "T" groove - Torque max. 0,3 Nm																				

END OF STROKE SENSORS TYPE SEX for potentially explosive environment ATEX

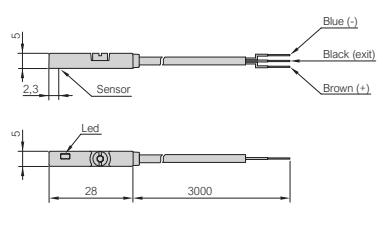
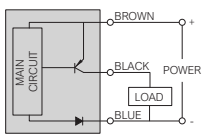
<p>SEX-21 End of stroke sensor HALL PNP - 3 poles N.O.</p> 	<p>Technical features</p>																				
	<table border="1"> <tr><td>Code</td><td>SEX-21</td></tr> <tr><td>Version</td><td>Cable 3 x 0,14 mm²</td></tr> <tr><td>Cable length</td><td>3000 mm</td></tr> <tr><td>Sensor</td><td>HALL</td></tr> <tr><td>Output</td><td>PNP, normally open</td></tr> <tr><td>Operating voltage</td><td>10 ÷ 28 Vdc</td></tr> <tr><td>Switching current (max.)</td><td>200 mA</td></tr> <tr><td>Contact rating (max.)</td><td>5,5 W</td></tr> <tr><td>Current consumption</td><td>10 mA (24 Vdc)</td></tr> <tr><td>Voltage drop (max.)</td><td>1,5 V</td></tr> </table>	Code	SEX-21	Version	Cable 3 x 0,14 mm ²	Cable length	3000 mm	Sensor	HALL	Output	PNP, normally open	Operating voltage	10 ÷ 28 Vdc	Switching current (max.)	200 mA	Contact rating (max.)	5,5 W	Current consumption	10 mA (24 Vdc)	Voltage drop (max.)	1,5 V
Code	SEX-21																				
Version	Cable 3 x 0,14 mm ²																				
Cable length	3000 mm																				
Sensor	HALL																				
Output	PNP, normally open																				
Operating voltage	10 ÷ 28 Vdc																				
Switching current (max.)	200 mA																				
Contact rating (max.)	5,5 W																				
Current consumption	10 mA (24 Vdc)																				
Voltage drop (max.)	1,5 V																				
	<table border="1"> <tr><td>Leakage current (max.)</td><td>0,05 mA</td></tr> <tr><td>Visual indicator</td><td>LED yellow diode</td></tr> <tr><td>Operating frequency</td><td>1000 Hz</td></tr> <tr><td>Temperature range</td><td>-10 ÷ +70 °C</td></tr> <tr><td>Enclosure classification (IEC 60529)</td><td>IP67</td></tr> <tr><td>Protection circuit</td><td>Short-circuit, power source reverse polarity, power-up pulse</td></tr> <tr><td>Mounting</td><td>Screw for "T" groove - Torque max. 0,3 Nm</td></tr> <tr><td>ATEX marking (2014/34/EU)</td><td>II 3GD Ex ic IIB T4 Gc Ex ic IIIC T135°C Dc</td></tr> </table> <p>SEX-21 / Sensor in PA, cable PVC - 1 piece each package</p>	Leakage current (max.)	0,05 mA	Visual indicator	LED yellow diode	Operating frequency	1000 Hz	Temperature range	-10 ÷ +70 °C	Enclosure classification (IEC 60529)	IP67	Protection circuit	Short-circuit, power source reverse polarity, power-up pulse	Mounting	Screw for "T" groove - Torque max. 0,3 Nm	ATEX marking (2014/34/EU)	II 3GD Ex ic IIB T4 Gc Ex ic IIIC T135°C Dc				
Leakage current (max.)	0,05 mA																				
Visual indicator	LED yellow diode																				
Operating frequency	1000 Hz																				
Temperature range	-10 ÷ +70 °C																				
Enclosure classification (IEC 60529)	IP67																				
Protection circuit	Short-circuit, power source reverse polarity, power-up pulse																				
Mounting	Screw for "T" groove - Torque max. 0,3 Nm																				
ATEX marking (2014/34/EU)	II 3GD Ex ic IIB T4 Gc Ex ic IIIC T135°C Dc																				

END OF STROKE SENSORS TYPE SHT for high temperature
SHT-21

End of stroke sensor REED - 2 poles N.O.

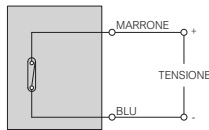
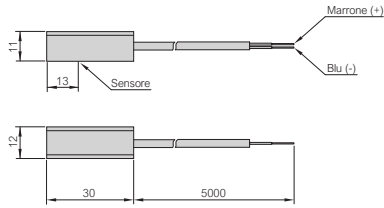

Technical features

Code	SHT-21
Version	Cable 2 x 0,14 mm ²
Cable length	5000 mm
Sensor	REED
Output	Pure contact, normally open
Operating voltage	5 ÷ 240 Vac / Vdc
Switching current (max.)	500 mA
Contact rating (max.)	10 W
Voltage drop (max.)	0,5 V
Visual indicator	None
Operating frequency	200 Hz
Temperature range	-10 ÷ +140 °C
Enclosure classification (IEC 60529)	IP67
Protection circuit	None
Mounting	Only with braket CC SHT

SHT-21 / Sensor in Al, cable in PTFE - 1 piece each package

THREADED CONNECTORS TYPE Y082LC SUITABLE FOR SRC-27
Y082LC ...

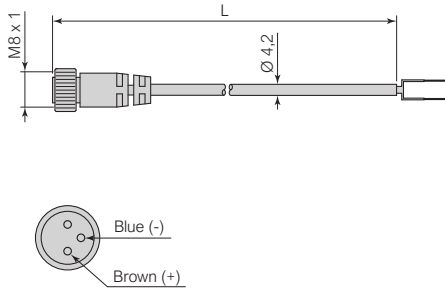
Threaded connectors - 2 poles

Technical features

Code	Y082LC250C	Y082LC500C
Threaded connector	M8 x 1	
End connector	Open	
Cable	2 x 0,14 mm ²	
Cable length (L)	2500 mm	5000 mm
Operating voltage (max.)	50 Vac / 60 Vdc	
Current (max.)	3000 mA	
Working temperature	-25 ÷ +75 °C	
Protection class (IEC 60529)	IP67	

Y082LC ... / Connector in PVC, contacts in gilded brass, cable in PVC - 1 piece each package

THREADED CONNECTORS TYPE Y083LC SUITABLE FOR SRD-27, SRN-27, SKC-27
Y083LC ...

Threaded connectors - 3 poles

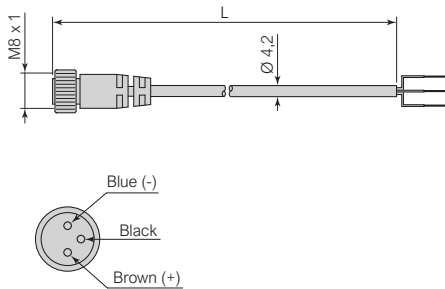
Technical features

Code	Y083LC250D	Y083LC500D
Threaded connector	M8 x 1	
End connector	Open	
Cable	3 x 0,14 mm ²	
Cable length (L)	2500 mm	5000 mm
Operating voltage (max.)	50 Vac / 60 Vdc	
Current (max.)	3000 mA	
Working temperature	-25 ÷ +75 °C	
Protection class (IEC 60529)	IP67	

Y083LC ... / Connector in PVC, contacts in gilded brass, cable in PVC - 1 piece each package

FIXING BRACKET TYPE SL.. - ST..**SL-81S - ST-52 - ST-60**

Fixing bracket for end of stroke sensor

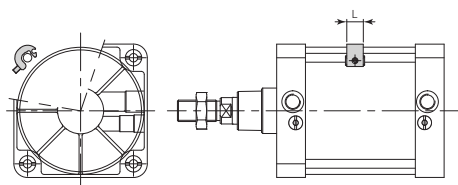

Bore mm	Code	L	Set head screw for fixing to cylinder
160	SL-81S	14	M5 x 10
200	SL-81S	14	M5 x 10
250	ST-60	14	M5 x 10
320	ST-52	14	M5 x 10

SL-... / ST-... Bracket: Anodised aluminium - Screw and plate: steel / 1 piece each package + 1 set head screw for fixing to cylinder

FIXING BRACKET TYPE CD SHT**CD SHT ...T**

Fixing bracket for SHT-21 end of stroke sensor

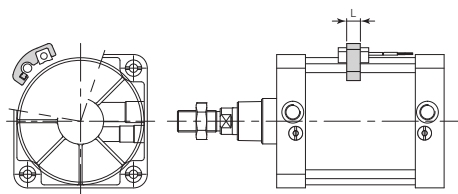

Bore mm	Code	L	Set head screw for fixing to sensor	Set head screw for fixing to cylinder
160	CD SHT 160T	12	M2,6 x 6	M4 x 10
200	CD SHT 200T	12	M2,6 x 6	M4 x 10
250	CD SHT 250T	12	M2,6 x 6	M4 x 10
320	CD SHT 320T	12	M2,6 x 6	M4 x 10

CD SHT ...T Alluminio anodizzato / 1 pezzo per confezione + 1 grano di fissaggio sensore SHT + 1 grano di fissaggio al cilindro



BONESI PNEUMATIK realizza tutti i suoi prodotti in Italia



BONESI PNEUMATIK s.r.l.

Via A. Robino n. 117
20025 Legnano (MI) Italy
P.I. / C.F. 10396340159
R.E.A. 1373315

www.bonesipneumatik.it
info@bonesipneumatik.it
Phone +39 0331 448000
Telefax +39 0331 448070

